

ÜRÜN VERİ SAYFASI

SKP DIN 46235 TİP KABLO PABUCU

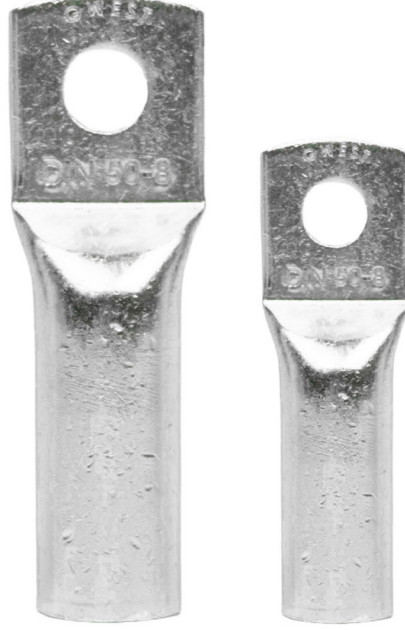

TANIM

Bir kablo pabucu, bir tel veya kablo gibi bir elektrikli cihaza bağlanır ve daha sonra bir kıvrım aleti ve kıvrım kalıbı kullanılarak ucuna güvenli bir şekilde sabitlenir.

ÖZELLİKLER

- EN/13600 standartlarında bakır malzemeden imal edilmiştir.
- Üretim esnasında tavlı bakır borular kullanılmıştır.
- Üretimde %99.9 oranında iletkenliğe sahip bakır kullanılmıştır.
- 5-8 Micron aralığında 100% Kalay kaplama yapılmaktadır.

SERTİFİKALAR



- CE standartlarında uygundur.
- RoHS standartlarında uygundur.
- ISO 9001 standartlarında uygundur.
- TSE standartlarında uygundur.
- IEC standartlarında uygundur.
- Yerli Üretim.

ÜRÜN VERİ SAYFASI

SKP DIN 46235 TİP KABLO PABUCU

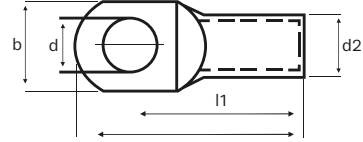
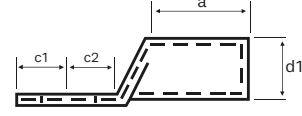

BÖLÜMLER VE BOYUTLAR

ÜRÜN KODU	KABLO KESİT (mm ²)	DELİK ÇAPID Ø	BOYUTLAR							
			d	d1	d2	l1	a	b	c1	c2
SKP-D 95-10	95 mm ²	M10	10,5	13,5	19,0	65,0	35,0	28,0	12,0	12,0
SKP-D 95-12		M12	13,0	13,5	19,0	65,0	35,0	28,0	13,0	13,0
SKP-D 95-16		M16	17,0	13,5	19,0	65,0	35,0	32,0	16,0	16,0
SKP-D 120-10	120 mm ²	M10	10,5	15,5	21,0	70,0	35,0	32,0	15,0	16,0
SKP-D 120-12		M12	13,0	15,5	21,0	70,0	35,0	32,0	16,0	17,0
SKP-D 120-16		M16	17,0	15,5	21,0	70,0	35,0	32,0	19,0	20,0
SKP-D 120-20		M20	21,0	15,5	21,0	70,0	35,0	38,0	21,0	22,0
SKP-D 150-10	150 mm ²	M10	10,5	17,0	23,5	78,0	35,0	34,0	15,0	16,0
SKP-D 150-12		M12	13,0	17,0	23,5	78,0	35,0	34,0	16,0	17,0
SKP-D 150-16		M16	17,0	17,0	23,5	78,0	35,0	34,0	19,0	20,0
SKP-D 150-20		M20	21,0	17,0	23,5	78,0	35,0	40,0	21,0	22,0
SKP-D 185-10	185 mm ²	M10	10,5	19,0	25,5	82,0	40,0	37,0	15,0	16,0
SKP-D 185-12		M12	13,0	19,0	25,5	82,0	40,0	37,0	16,0	17,0
SKP-D 185-16		M16	17,0	19,0	25,5	82,0	40,0	37,0	19,0	20,0
SKP-D 185-20		M20	21,0	19,0	25,5	82,0	40,0	40,0	21,0	22,0
SKP-D 240-12	240 mm ²	M12	13,0	21,5	29,0	92,0	40,0	42,0	16,0	17,0
SKP-D 240-16		M16	17,0	21,5	29,0	92,0	40,0	42,0	19,0	20,0
SKP-D 240-20		M20	21,0	21,5	29,0	92,0	40,0	45,0	21,0	22,0
SKP-D 300-16	300 mm ²	M16	17,0	24,5	32,0	100,0	50,0	48,0	19,0	22,0
SKP-D 300-20		M20	21,0	24,5	32,0	100,0	50,0	48,0	22,0	22,0